

Instructions for Extensions 5106 / 5107

For use with gate models: 5108, 5108S, 5268, 5268S

Important: Please keep for further reference.

For helpful tips and instructions, please visit our website: www.northstatesind.com
or contact our Customer Care department via email: CustomerService@northstatesind.com
Phone (763) 486-1754 or Toll Free: (800) 848-8421

**NOTE: When using multiple extensions, place as equally as possible on either side of the gate frame.
The maximum number of extensions that can be used with this gate is three.**

Installation and Operation

Step 1: Measure the width of the opening where you intend to install the gate. Please refer to the chart below to determine the correct installation configuration.

Step 2: To add an extension to the gate, insert the extension pins into the holes on the outside of the gate frame. Next, slip the extension over the pins. Finally, slide the spindles with tension knobs completely into the holes on the outside of the extension.

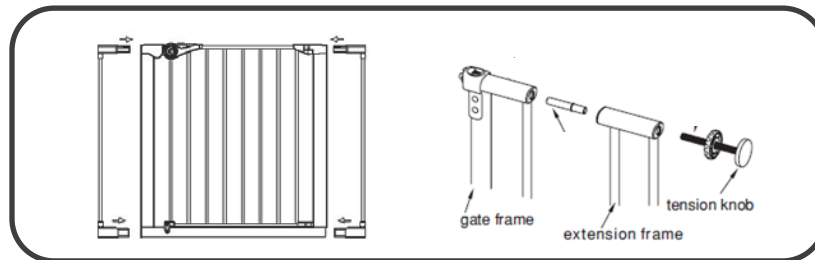

Gate frame

<i>Extensions Needed</i>	<i>Opening Size Range</i>
None	29.8" – 32.6"
1-Bar	32.5" – 35.4"
1-Bar + 1-Bar	35.3" – 38.1"
2-Bar	35.3" – 38.1"
2-Bar + 1-Bar	38.0" – 40.9"
2-Bar + 1-Bar + 1-Bar	40.8" – 43.6"
2-Bar + 2-Bar	40.8" – 43.6"
4-Bar	40.8" – 43.6"
2-Bar + 2-Bar + 1-Bar	43.5" – 46.4"
4-Bar + 1-Bar	43.5" – 46.4"
2-Bar + 2-Bar + 2-Bar	46.3" – 49.1"
4-Bar + 1-Bar + 1-Bar	46.3" – 49.1"
4-Bar + 2-Bar + 1-Bar	49.0" – 51.9"
4-Bar + 2-Bar + 2-Bar	51.8" – 54.6"
4-Bar + 4-Bar + 1-Bar	54.5" – 57.4"
4-Bar + 4-Bar + 2-Bar	57.3" – 60.1"

1-Bar
2 ¾" Extension
(2 Extensions included with gate)

Model 5106
2-Bar
6" Extension
(sold separately)

Model 5107
4-Bar
12" Extension
(sold separately)