

## Instructions for Extension 4974 / 4975

Extension 4974 for use with 30" high gate model: 4977  
 Extension 4975 for use with 36" high gate model: 4978

### Important: Please keep for further reference.

For helpful tips and instructions, please visit our website: [www.northstatesind.com](http://www.northstatesind.com)  
 or contact our Customer Care department via email: [CustomerService@northstatesind.com](mailto:CustomerService@northstatesind.com)  
 Phone (763) 486-1756 or Toll Free: (800) 848-8421

**NOTE: When using multiple extensions, place as equally as possible on either side of the gate frame.  
 The maximum number of extensions that can be used with this gate is four.**

### Installation and Operation

**Step 1:** Measure the width of the opening where you intend to install the gate. Please refer to the chart below to determine the correct installation configuration.

**Step 2:** To add an extension to the gate, remove and discard the protection bushings marked with "REMOVE". Insert upper bushings and lower bushings into the gate frame or extension(s). Place extension(s) into gate frame. Slide the 4 tension bolts with rubber pads completely into the bushings. When installing and detaching the extension(s), move the extension(s) in an upright position, do not tilt.

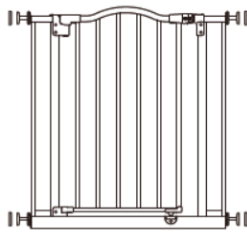
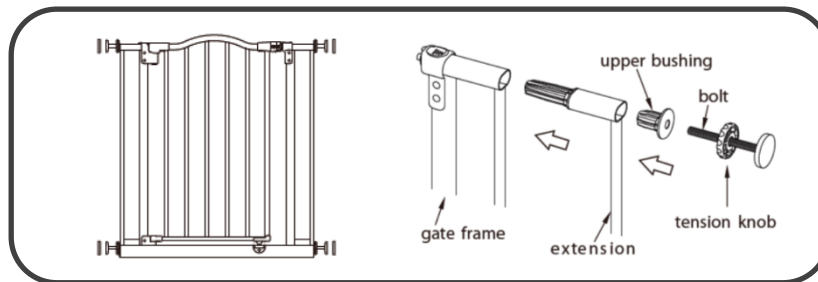

Gate frame

<i>Extensions Needed</i>	<i>Opening Size Range</i>
None	28.2" – 31.4"
1-Bar	31.1" – 34.2"
1-Bar + 1-Bar	33.8" – 37"
4-Bar	38.2" – 41.4"
1-Bar + 4-Bar	40.8" – 44"
1-Bar + 1-Bar + 4-Bar	43.5" – 46.8"
5-Bar	41.7" – 44.9"
1-Bar + 5-Bar	44.5" – 47.7"
1-Bar + 1-Bar + 5-Bar	47.3" – 50.5"
4-Bar + 5-Bar	51.7" – 54.9"
1-Bar + 4-Bar + 5-Bar	54.5" – 57.7"
1-Bar + 1-Bar + 4-Bar + 5-Bar	57.3" – 60.5"

