

Instructions for Extensions 4918 / 4919 / 4962 / 4963

Extensions 4918 / 4919 for use with white gate model: 4913
 Extensions 4962 / 4963 for use with gray gate model: 4926

Important: Please keep for further reference.

For helpful tips and instructions, please visit our website: www.northstatesind.com
 or contact our Customer Care department via email: CustomerService@northstatesind.com
 Phone (763) 486-1756 or Toll Free: (800) 848-8421

NOTE: When using multiple extensions, place as equally as possible on either side of the gate frame.
The maximum number of extensions that can be used with this gate is three.

Installation and Operation

Step 1: Measure the width of the opening where you intend to install the gate. Please refer to the chart below to determine the correct installation configuration.

Step 2: To add an extension to the gate, insert the extension pins into the holes on the outside of the gate frame. Note: the long ends of the pins go into the gate frame, while the short ends go into the long ends of the extension frames. Next, slip the extension over the pins. Finally, slide the tension bolts with rubber pads completely into the holes on the outside of the extension.

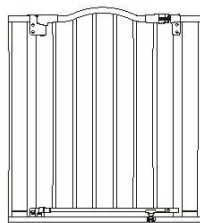
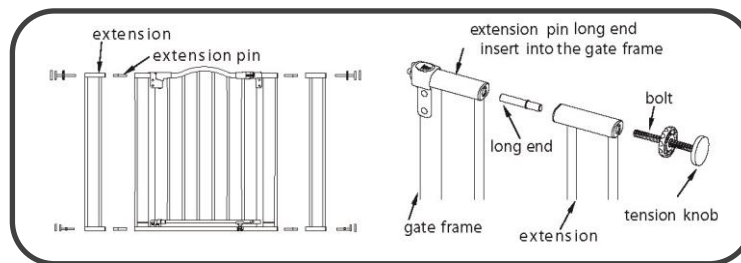

Gate frame

<i>Extensions Needed</i>	<i>Opening Size Range</i>
None	28.75" – 30.75"
2-Bar	32.50" – 34.50"
2-Bar + 2-Bar	36.25" – 38.25"
2-Bar + 3-Bar	39.88" – 41.88"
2-Bar + 2-Bar + 3-Bar	43.63" – 45.63"
2-Bar + 3-Bar + 3-Bar	47.25" – 49.25"
3-Bar + 3-Bar + 3-Bar	50.88" – 52.88"
2-Bar + 2-Bar + 4-Bar	47.13" – 49.13"
2-Bar + 3-Bar + 4-Bar	50.75" – 52.75"
3-Bar + 3-Bar + 4-Bar	54.38" – 56.38"
2-Bar + 4-Bar + 4-Bar	54.25" – 56.25"
3-Bar + 4-Bar + 4-Bar	57.88" – 59.88"
4-Bar + 4-Bar + 4-Bar	61.38" – 63.38"

2-Bar
 3 3/4" Extension
 (2 Extensions
 included with gate)



Model 4918 - white
 Model 4962 - gray
 3-Bar
 7 1/4" Extension
 (sold separately)



Model 4919 – white
 Model 4963 - gray
 4-Bar
 10 3/4" Extension
 (sold separately)

