

Instructions for Extension 4900

For use with gate models: 4916, 4917

Important: Please keep for further reference.

For helpful tips and instructions, please visit our website: www.northstatesind.com
or contact our Customer Care department via email: CustomerService@northstatesind.com
Phone (763) 486-1754 or Toll Free: (800) 848-8421

**NOTE: When using multiple extensions, place as equally as possible on either side of the gate frame.
The maximum number of extensions that can be used with this gate is three.**

Installation and Operation

Step 1: Measure the width of the opening where you intend to install the gate. Please refer to the chart below to determine the correct installation configuration.

Step 2: To add an extension to the gate, insert the extension pins into the holes on the outside of the gate frame. Next, slip the extension over the pins. Finally, slide the spindles with tension knobs into the holes on the outside of the extension.

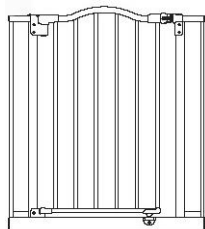
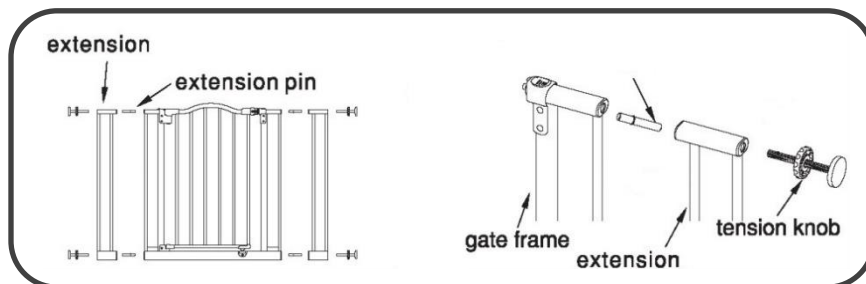

Gate frame

<i>Extensions Needed</i>	<i>Opening Size Range</i>
None	28.25" – 30.75"
2-Bar	31.75" – 34.25"
2-Bar + 2-Bar	35.25" – 38.25"
5-Bar	41.75" – 44.25"
2-Bar + 5-Bar	45.25" – 47.75"
2-Bar + 2-Bar + 5-Bar	48.75" – 51.25"
2-Bar + 5-Bar + 5-Bar	58.75" – 61.25"
5-Bar + 5-Bar + 5-Bar	68.75" – 71.25"



2-Bar
3 3/4" Extension
(2 Extensions included with gate)



Model 4900
5-Bar
13 1/2" Extension
(sold separately)